

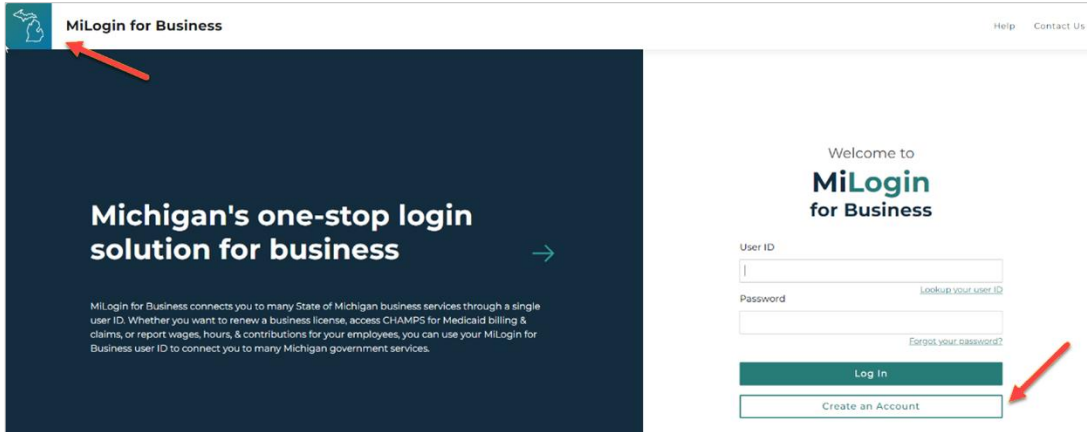

MiLogin QR VERA

To access VERA, you will need to register for a State of Michigan MiLogin ID and subscribe to the VERA application. If you already have a MiLogin ID, please start at **Step 13** on page 5. To create a MiLogin ID, please follow the steps below.

Step 1: Go to the MiLogin website: MiLoginTP.Michigan.gov



Step 2: Click the **Create an Account** button.

Step 3: Enter your e-mail, select the **I'm not a robot** check box, and click **Next Step**.

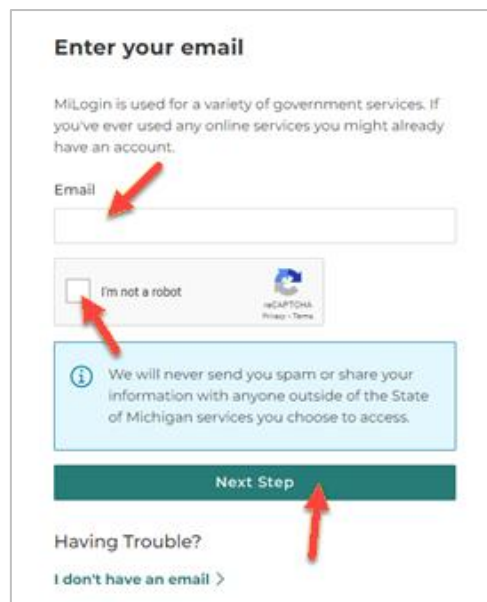
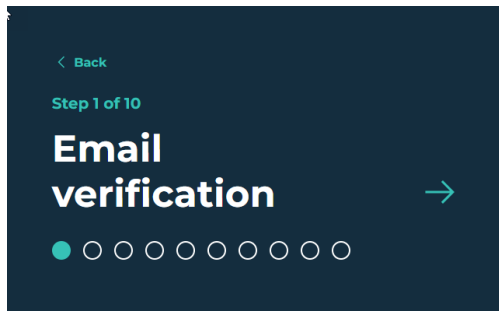



MiLogin QR VERA

Step 4: Enter the passcode sent to the e-mail address used to register for your MiLogin account.

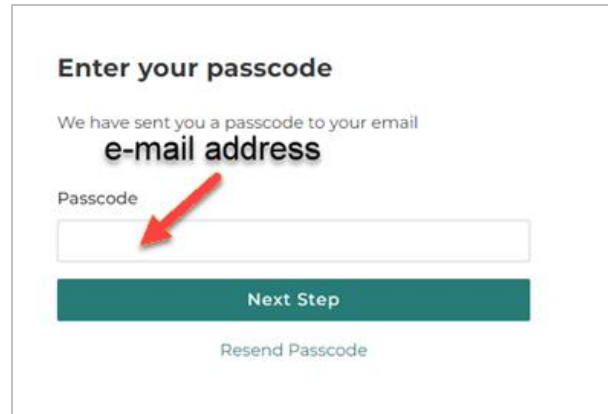
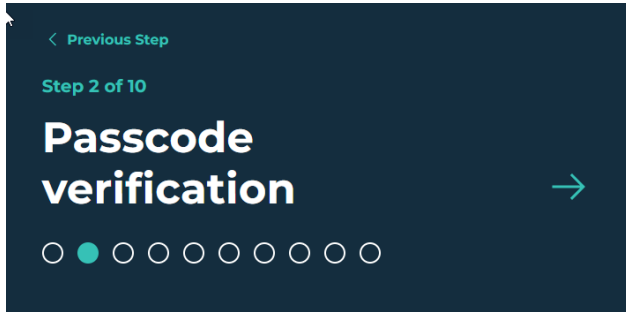

Step 5: Enter your information including **FIRST** and **LAST** name. Agree to the **Terms & Conditions** by checking the box and click **Next Step**

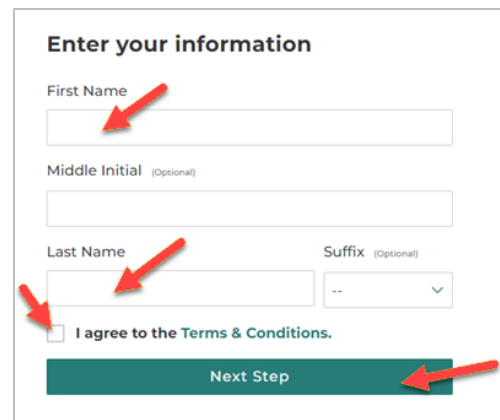
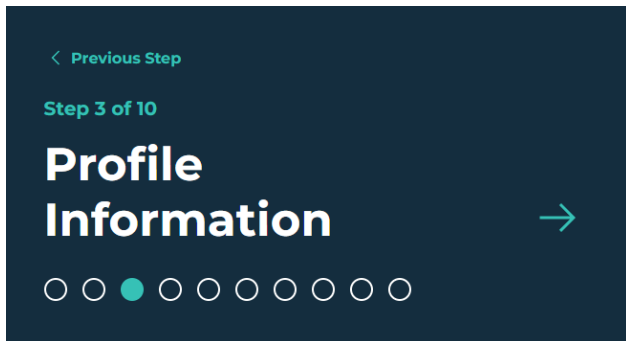

Step 6: Enter your work phone number and click **Next Step**.

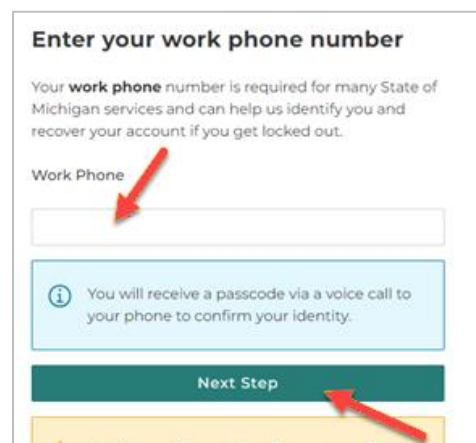
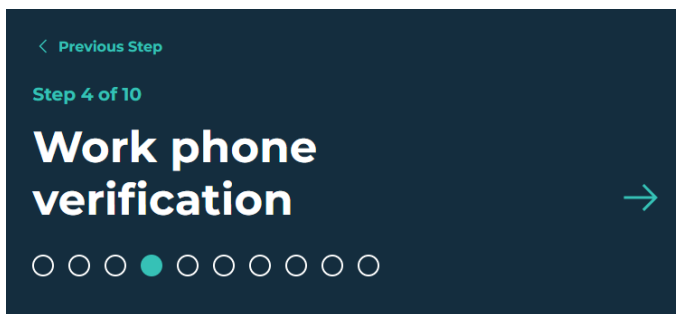



MiLogin QR VERA

Step 7: Enter the passcode receive via telephone call to your work number provided or choose skip verification. **Click Confirm Passcode.**

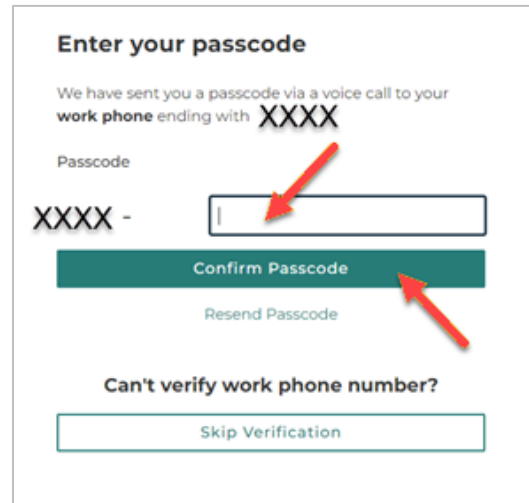
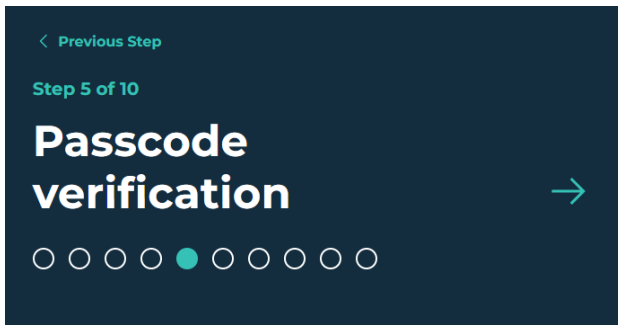

Step 8: Enter your mobile phone number and click **Next Step** OR choose **Skip this for now.**

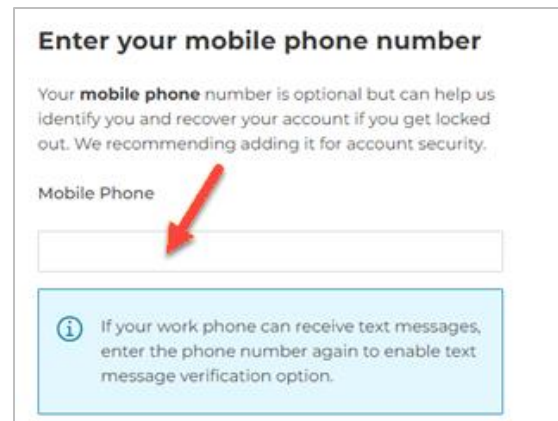
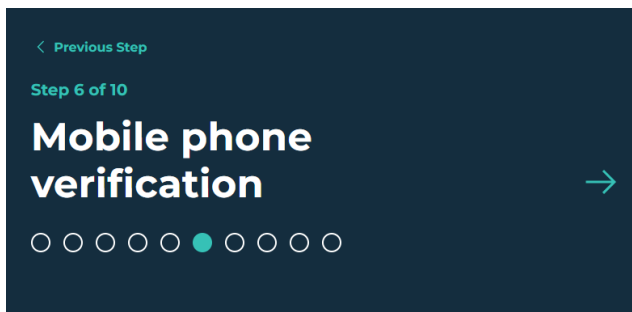

Step 9: Select a verification method – **Text Message** or **Voice Call.**

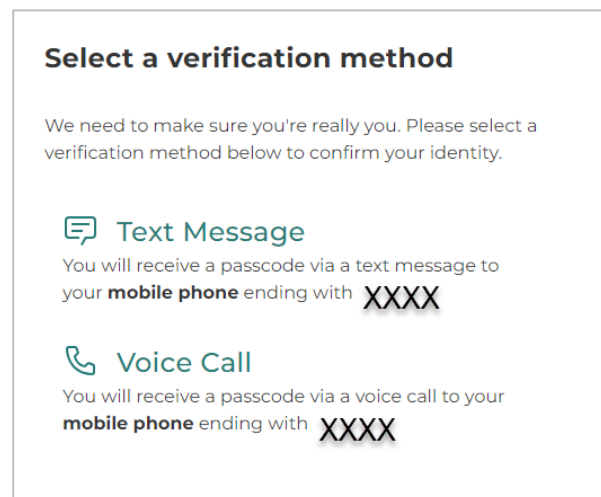
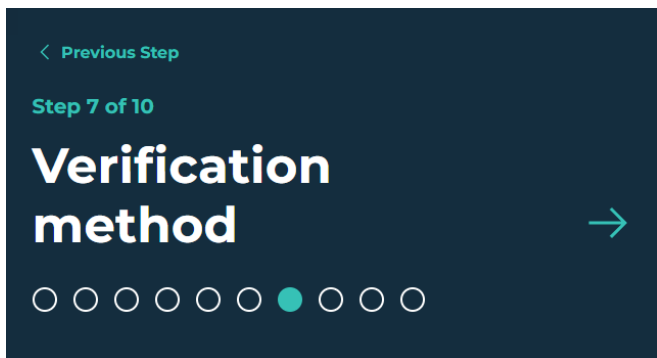



MiLogin QR VERA

Step 10: Enter the passcode provided either via text message to your mobile phone number or voice recording to your mobile phone and click **Confirm Passcode**.

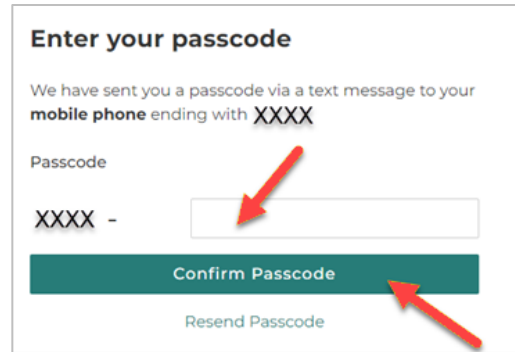
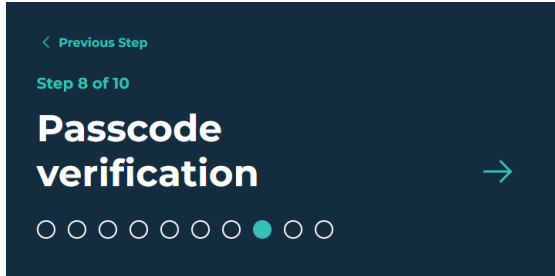

Step 11: Create your user ID and click **Next Step**.

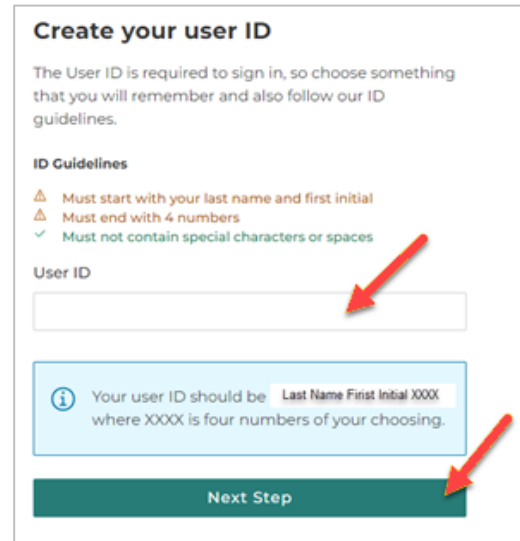
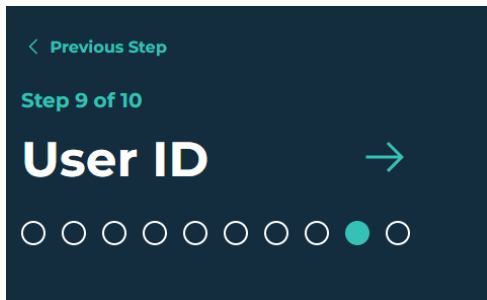

Please Note: User IDs must be in the format of last name followed by first initial and then four digits.

Step 12: Create your password. Please follow the Password Guidelines provided. Click **Create Account**.

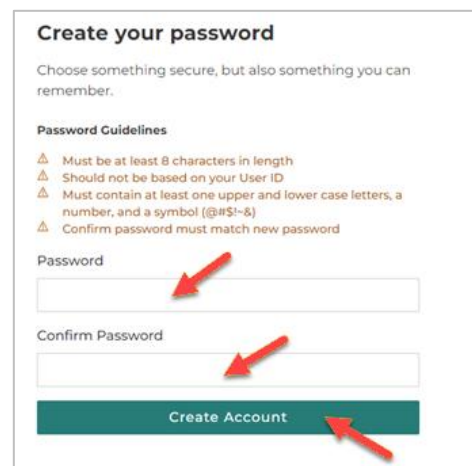
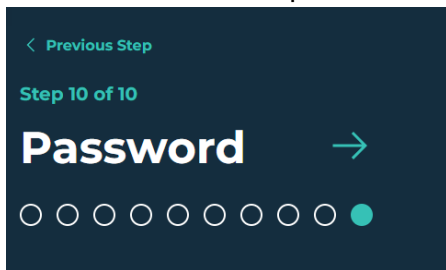

Your MiLogin account has been successfully created. Please move to step 13 to request access to the VERA application.



MiLogin QR VERA

Step 13: Select the **Find Services** link at the bottom of the **Discover Online Services** box or click **Discover Online Services** at the top of the page.

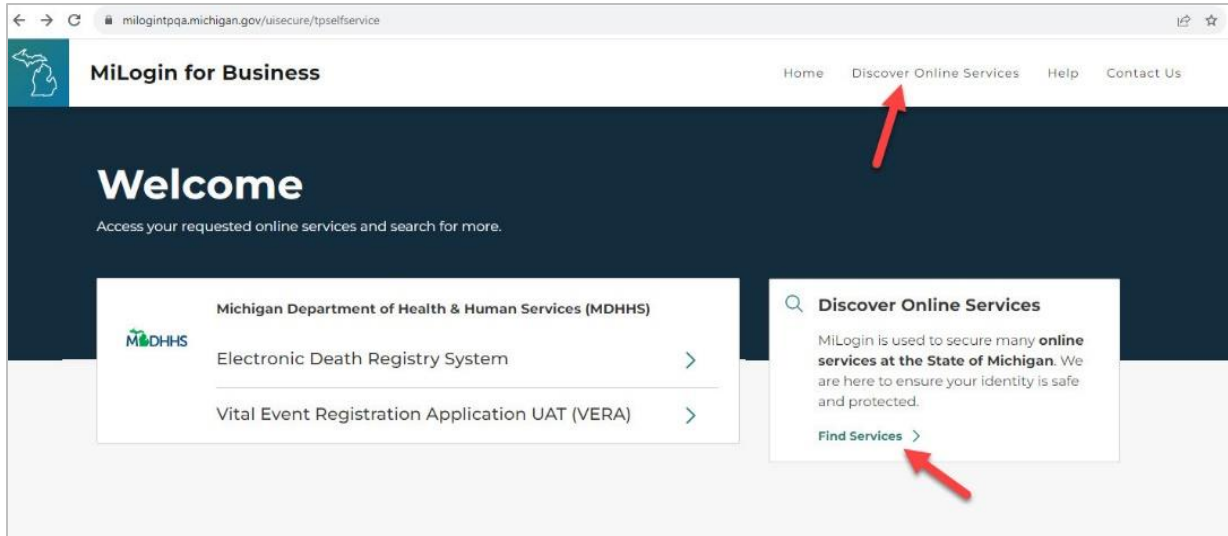

Step 14: You can find the VERA application by either using the **Search for Services** box and typing Vital Event Registration DEV (VERA) *OR* under **Filter by Departments** by selecting the box next to Michigan Department of Health & Human Services (MDHHS).

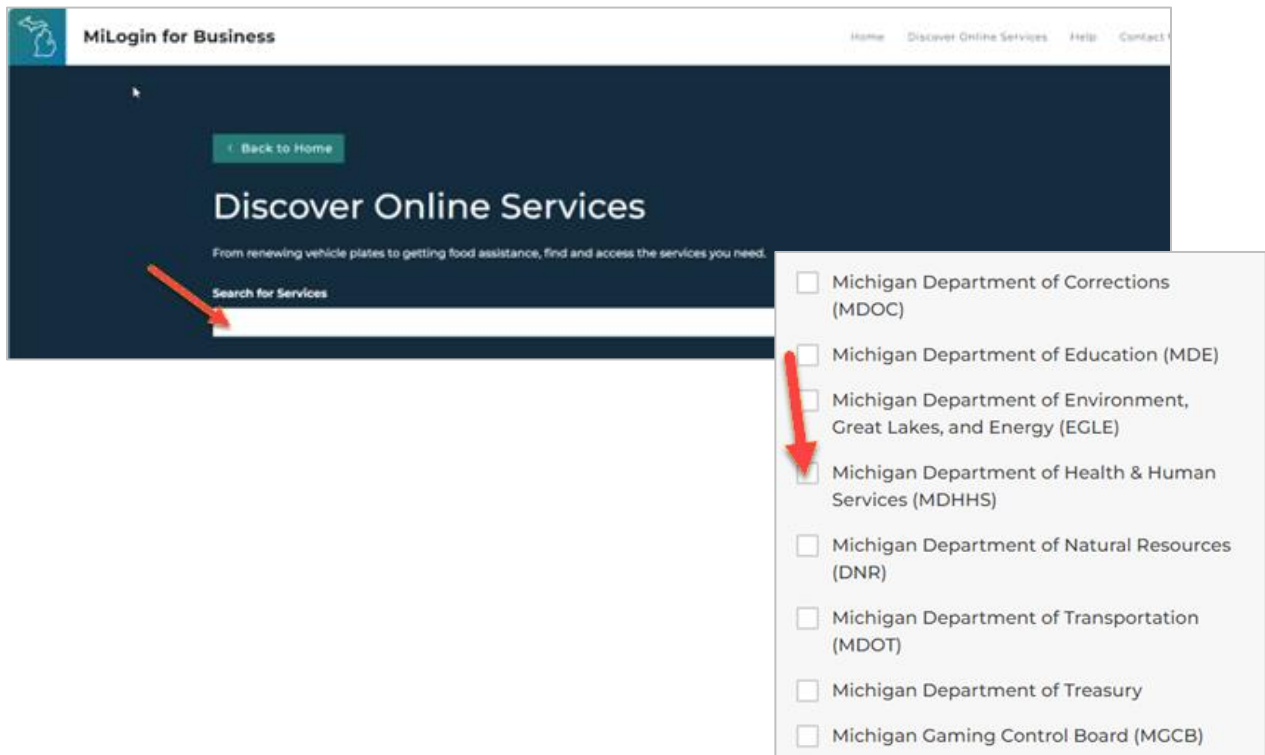



MiLogin QR VERA

Step 15: Scroll down and choose the **Vital Event Registration DEV (VERA)** application.

Vital Event Registration Application DEV (VERA)

The Vital Event Registration Application (VERA) enables authorized requestors to register new vital records for the State of Michigan.

Step 16: Agree to the Terms & Conditions by selecting the checkbox next to **I agree to the Terms & Conditions** and click **Request Service**. Your request is being processed. A system generated e-mail will be sent to the e-mail address used to register when your profile has been approved. You will see the application link on your home page upon approval.

Vital Event Registration Application Training (VERA)

The Vital Event Registration Application (VERA) enables authorized requestors to register new vital records for the State of Michigan.

Please accept the Terms and Conditions to continue:

Terms & Conditions

The Michigan Department of Health & Human Services (MDHHS) computer information system (systems) are the property of the State of Michigan and subject to state and federal laws, rules and regulations. The systems are intended for use only by authorized persons and only for official state business. Systems users are prohibited from using any assigned or entrusted access control mechanisms for any purposes other than those required to perform authorized data exchange with MDHHS. Logon IDs and passwords are never to be shared. Systems users must not disclose any confidential, restricted or sensitive data to unauthorized persons. Systems users will only access information on the systems for which they have authorization. Systems users will not use MDHHS systems for commercial or partisan political purposes. Following industry standards, systems users must securely maintain any information downloaded.

I agree to the Terms & Conditions

Request Service

Vital Event Registration Application Training (VERA)

The Vital Event Registration Application (VERA) enables authorized requestors to register new vital records for the State of Michigan.

Your request is being processed

We have received your request and it is under review. **You will be notified via email when access is granted.**
You will be able to launch the service, once the access is granted.

Continue



MiLogin QR VERA

Review Your Contact Information

1. The system will default to the e-mail address and phone number used when registering for MiLogin.
2. Review this information displayed and click the **Submit** button to submit your request.

Confirmation Message

Clicking the Submit button sends the request and displays a confirmation message.

Once approved, you will see the VERA application on your MiLogin Homepage the next time you login.

***NOTE:** Subscription requests and approval may take 24-48 hours to process.*

In addition to creating a MiLogin ID and subscribing to VERA, all users must complete a security agreement and VERA training. Proof of training completion must be submitted with the security agreement.

Additionally, birth specialists and licensed midwives will be required to take the NCHS online course: Applying Best Practices for Reporting Medical and Health Information on Birth Certificates www.cdc.gov/nchs/training/BirthCertificateElearning/ and submit a certificate of completion.

Please email the security agreement and proof of training completion (all users) and certificate of completion of the NCHS online course (birth specialists and licensed midwives) to:

MDHHS-VERA-help@michigan.gov.

***NOTE:** Subscription requests and approval may take 24-48 hours to process once all required documentation is received.*

Upon your first login after your account is fully approved, you will complete set up by inputting additional information. On subsequent logins, you will only need to input your user ID and password to access your account.